



Size 12 Expanded Beam Contacts

Pin and Socket Contacts for MIL-DTL-38999

Sabritec's Expanded Beam Fiber Optic Contact technology is specifically designed to fit into standard size 12 cavities of MIL-DTL-38999 Series I, III and IV connectors. The size 12 contact provides a robust fiber optic interconnection with low susceptibility to contamination and fits a variety of cable types with diameters from 1.6 to 2.2 mm with additional versions available upon request. The contacts are rear release/rear removable with standard size 12 removal tools.



Size 12 Expanded Beam Pin Contact

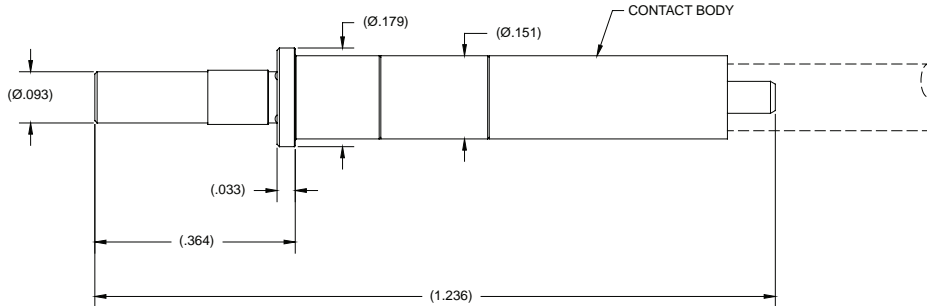

PN: 238633-8000

Size 12 Expanded Beam Socket Contact

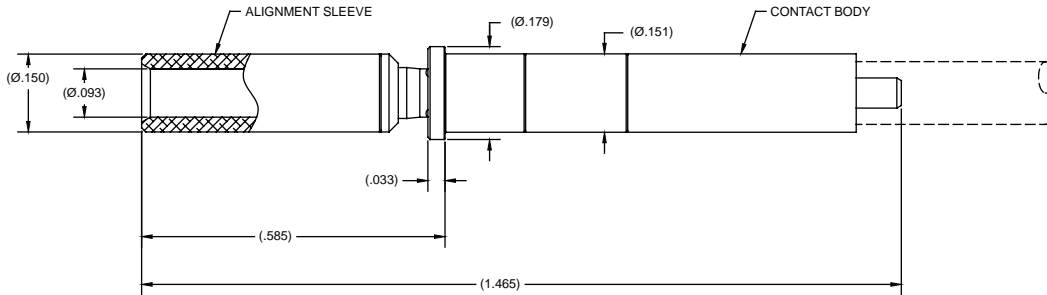

PN: 238733-8000

Sample Size 12 Insert Arrangements

Standard Insert Arrangements for MIL-STD-1560

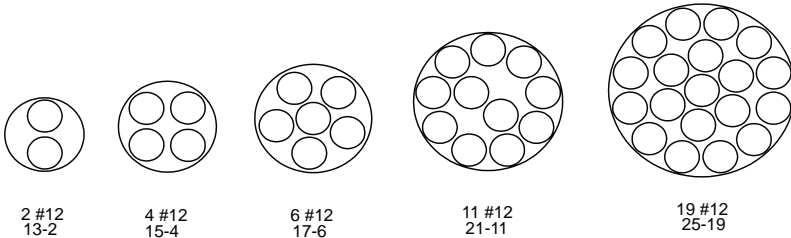

Specifications	
Operating Temperature	-40°C to + 85°C
Fiber Types	Multimode: 50/125 µm 62.5/125 µm
Insertion Loss	1.0 dB (Typical)
Cable Diameter	1.6mm to Ø2.2mm
Ferrules	Zirconia Ceramic
Contact Body	ARCAP
Alignment Sleeve	Stainless Steel